

Galley® Line

Sanitary, Heavy Duty Cashier's Station Modules

Item No. _____

Model No. 9407	Model No. 9412
Model No. 9408	Model No. 9413
Model No. 9409	Model No. 9414
Model No. 9410	Model No. 9826
Model No. 9411	Model No. 9827

A1A11420

- Aesthetic design, three neutral colors, dove white, pewter tan, or black pearl blend in with any surroundings.
- Four built-in & concealed stainless steel handles allow easy portability.
- Self-locking and self-aligning features eliminate time consuming hookup.
- Lightweight but extra-strong construction provides ease of mobility.
- Casters and brakes are almost completely concealed from patron's view.
- Soft textured surfaces and rounded corners help prevent skin cuts and clothing snags.

Does not include Cash Register



U.S. PATENT NUMBERS 4,008,931 AND 244,735

<p style="text-align: center;">28" Cashier Module</p>	<table border="0"> <tr> <td>9407</td> <td>Optional</td> <td>Cashier Module – Right End Cashier</td> <td>28"</td> <td>28"</td> <td>36"</td> <td>85</td> <td>240</td> </tr> <tr> <td>9408</td> <td>Optional</td> <td>Cashier Module – Left End</td> <td>28"</td> <td>28"</td> <td>36"</td> <td>85</td> <td>240</td> </tr> <tr> <td>9826</td> <td>Optional</td> <td>Cashier Module - same as 9407 with door & lock</td> <td>28"</td> <td>28"</td> <td>36"</td> <td>85</td> <td>290</td> </tr> <tr> <td>9827</td> <td>Optional</td> <td>Cashier Module - same as 9408 with door & lock</td> <td>28"</td> <td>28"</td> <td>36"</td> <td>85</td> <td>290</td> </tr> </table> <p>Cash Drawer and Lock replaces one mate-lock end. 9407 & 9826 have cash drawer on male end and one female end. 9408 & 9827 have cash drawers on female end and one male end. Open in back. One shelf included. Optional Closure Panel: #8733. Optional Tray Slide (s): #8772 or #8773 (extends tray slide 14 7/8" to 42 7/8"). Optional Electrical Outlet: #8696 (Top Mount), #8698 (Under Top) or Electric Cord Cutout (No Outlet): #8881.</p>	9407	Optional	Cashier Module – Right End Cashier	28"	28"	36"	85	240	9408	Optional	Cashier Module – Left End	28"	28"	36"	85	240	9826	Optional	Cashier Module - same as 9407 with door & lock	28"	28"	36"	85	290	9827	Optional	Cashier Module - same as 9408 with door & lock	28"	28"	36"	85	290
9407	Optional	Cashier Module – Right End Cashier	28"	28"	36"	85	240																										
9408	Optional	Cashier Module – Left End	28"	28"	36"	85	240																										
9826	Optional	Cashier Module - same as 9407 with door & lock	28"	28"	36"	85	290																										
9827	Optional	Cashier Module - same as 9408 with door & lock	28"	28"	36"	85	290																										
<p style="text-align: center;">50" Cashier Module (9409 Shown)</p>	<table border="0"> <tr> <td>9409</td> <td>Optional</td> <td>Cashier Module – Right End</td> <td>50"</td> <td>28"</td> <td>36"</td> <td>85</td> <td>340</td> </tr> <tr> <td>9410</td> <td>Optional</td> <td>Cashier Module – Left End</td> <td>50"</td> <td>28"</td> <td>36"</td> <td>85</td> <td>340</td> </tr> </table> <p>Cash Drawer and Lock replaces one mate-lock end. 9409 has cash drawer on male end. 9410 has cash drawer on female end. Open in back. One shelf included. Optional Tray Slide (s): #8774. Optional Closure Panel: #8734. Optional Electrical Outlet: #8696 (Top Mount), #8698 (Under Top). Optional Electric Cord Cutout (No Outlet): #8881.</p>	9409	Optional	Cashier Module – Right End	50"	28"	36"	85	340	9410	Optional	Cashier Module – Left End	50"	28"	36"	85	340																
9409	Optional	Cashier Module – Right End	50"	28"	36"	85	340																										
9410	Optional	Cashier Module – Left End	50"	28"	36"	85	340																										
<p style="text-align: center;">64.5" Cashier Module (9411 Shown)</p>	<table border="0"> <tr> <td>9411</td> <td>Optional</td> <td>Cashier Module – Right End</td> <td>64.5"</td> <td>28"</td> <td>36"</td> <td>85</td> <td>405</td> </tr> <tr> <td>9412</td> <td>Optional</td> <td>Cashier Module – Left End</td> <td>64.5"</td> <td>28"</td> <td>36"</td> <td>85</td> <td>405</td> </tr> </table> <p>Cash Drawer and Lock replaces one mate-lock end. 9411 has cash drawer on male end. 9412 has cash drawer on female end. Open in back. One shelf included. Optional Tray Slide (s): #8776. Optional Closure Panel: #8735. Optional Electrical Outlet: #8696 (Top Mount), #8698 (Under Top). Optional Electric Cord Cutout (No Outlet): #8881.</p>	9411	Optional	Cashier Module – Right End	64.5"	28"	36"	85	405	9412	Optional	Cashier Module – Left End	64.5"	28"	36"	85	405																
9411	Optional	Cashier Module – Right End	64.5"	28"	36"	85	405																										
9412	Optional	Cashier Module – Left End	64.5"	28"	36"	85	405																										
<p style="text-align: center;">79" Cashier Module (9413 Shown)</p>	<table border="0"> <tr> <td>9413</td> <td>Optional</td> <td>Cashier Module – Right End</td> <td>79"</td> <td>28"</td> <td>36"</td> <td>85</td> <td>450</td> </tr> <tr> <td>9414</td> <td>Optional</td> <td>Cashier Module – Left End</td> <td>79"</td> <td>28"</td> <td>36"</td> <td>85</td> <td>450</td> </tr> </table> <p>Cash Drawer and Lock replaces one mate-lock end. 9413 has cash drawer on male end. 9414 has cash drawer on female end. Open in back. One shelf included. Optional Tray Slide (s): #8778. Optional Closure Panel: #8736. Optional Electrical Outlet: #8696 (Top Mount), #8698 (Under Top). Optional Electric Cord Cutout (No Outlet): #8881.</p>	9413	Optional	Cashier Module – Right End	79"	28"	36"	85	450	9414	Optional	Cashier Module – Left End	79"	28"	36"	85	450																
9413	Optional	Cashier Module – Right End	79"	28"	36"	85	450																										
9414	Optional	Cashier Module – Left End	79"	28"	36"	85	450																										

Galley® Line

Cashier's Station Module

Model No. 9407, 9408, 9409, 9410, 9411, 9412, 9413, 9414, 9826, 9827

To be **Galley® Line** Economy Cashier Module, Model _____ with accessories as specified.

GENERAL: Unit to be self-contained, mobile Cashier Module. Body material to be one of three neutral base colors, dove white, pewter tan or black pearl. "Matelock" self-locking and aligning end panels allow modules to be interconnected. Unit to include metal cash drawer and stainless steel under shelf. To have recessed push handles at one end. Two removable side panels to be recessed to accept decorator panels. To be listed by National Sanitation Foundation and Underwriters' Laboratories, Inc.

CONSTRUCTION: Body material to be of flame retardant ABS formed plastic fastened to a galvanneal undercarriage. 14 ga. 300 series stainless steel top to have not less than #4 finish. Unit to have bottom shelf for foot rest. Cash drawer to be mounted on the end of the line. Plate mounted 4" diameter swivel casters with toe brakes to be provided.

Specifications subject to change without notice.

ACCESSORIES:

A. Decorator panels, specify catalog number and quantity. (See chart on front side).

Catalog No. 8700 American Walnut, Quantity _____ Included.

Catalog No. 8701 Teakwood, Quantity _____.

Catalog No. 8702 Plain Custom Panel, Quantity _____.

B. Folding Trayslides. All stainless steel with die-stamped three-rib reinforcement.

Catalog No. 8771, (*Short 28") 20⁷/₈" width.

Catalog No. 8772, 28" width.

***Note:** A short trayslide must be used on the first module to the right of Corner In-Fill Module for inside turns.

C. Extension shelf. Stainless steel. Mounted flush with top of module. Self-mounting. 16" wide x 28" deep.

Catalog No. 8754.

D. "Mateflat" Panel. (Makes any Galley unit compatible with any other serving line equipment or for squaring unit to wall.) Size 5⁵/₈"W x 28"D x 36"H.

Catalog No. 8761 Male Panel (Fits female end).

Catalog No. 8762 Female Panel (Fits male end).

E. Low End Shelf. Self-mounting. 16" wide x 28" deep.

Catalog No. 8725.

F. Flat End Panel.

Catalog No. 8731. Use on 9407.

Catalog No. 8732. Use on 9408.

SPECIFICATION DRAWING OF BASIC UNIT

Model 9407

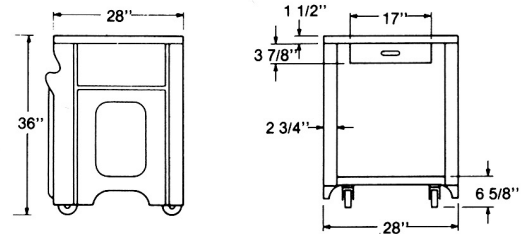
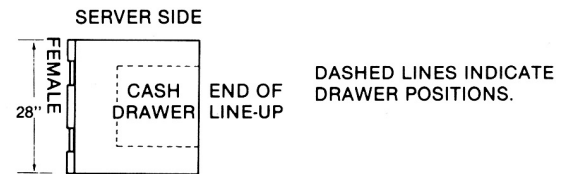

Model 9408

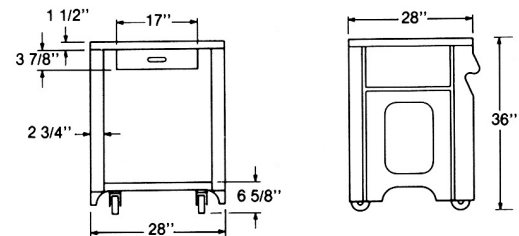
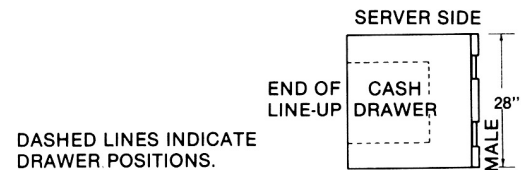

NOTE: If unit is to be used independently, add 4" to width for clearance on all specifications. Add 3 1/2" to depth for folded trayslide.

Galley®

50 South US Highway One

Jupiter, FL 33477-5107

Phone: 1-561-748-5200

Fax: 1-561-748-5250

Web Site: www.galleyline.com